

Common Mode Filter

FEATURES

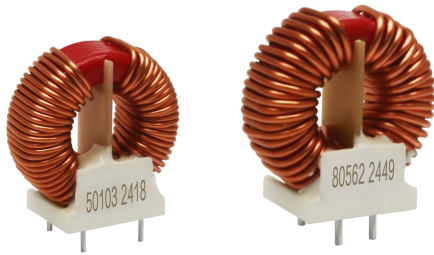

RoHS

- Good temperature characteristic (-40 °C ~+125°C)
- Compact size
- Effective anti-interference
- High reliability

It is suitable for analog circuits where noise and EMC are sensitive, and the EMC level can be significantly improved by adding a product to the input end of the power module.

Selection Guide

Model	Inductance (μ H)(min)	Inductance (μH)(typ)	Current (A)(max)	DCR(mΩ) (typ)	Weight (g) (typ)	Size(mm) (L*W*H)
FL2D-50-102	700*2	1000*2	5.0	30*2	13	23*13.2*23
FL2D-50-332	2300*2	3300*2	5.0	38*2	13	23*13.2*23
FL2D-50-562	3900*2	5600*2	5.0	47*2	13	23*13.2*23
FL2D-50-103	7000*2	10000*2	5.0	56*2	18	27*13.2*27
FL2D-80-102	700*2	1000*2	8.0	30*2	15	23*13.2*23
FL2D-80-332	2300*2	3300*2	8.0	30*2	15	23*13.2*23
FL2D-80-562	3900*2	5600*2	8.0	38*2	20	27*13.2*27

General Specifications

Item	Test Conditions	Min.	Typ.	Max.	Unit
Operating Temperature*① (FL2D-50-102、 FL2D-80-102)		-40	--	125	°C
Operating Temperature*②(Other models)		-40	--	115	
Storage Temperature		-40	--	115	
Welding Temperature	Wave soldering welding,10 seconds MAX	+255	+260	+265	
Storage Humidity		--	--	95	%
Inductance Error Range	fo=1KHz, Uo=0.3V	--	30	--	%
Isolation (COIL-COIL)	Leakage current Io≤5mA,	--	--	1500	VAC
		--	--	2000	VDC

Note: *Operating Temperature range includes inductor self heating.

Schematic diagram of pin Mark

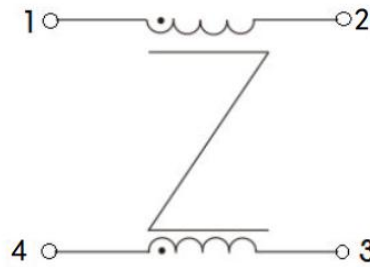

FL2D-50-xxx Insertion Loss Specifications (reference value)

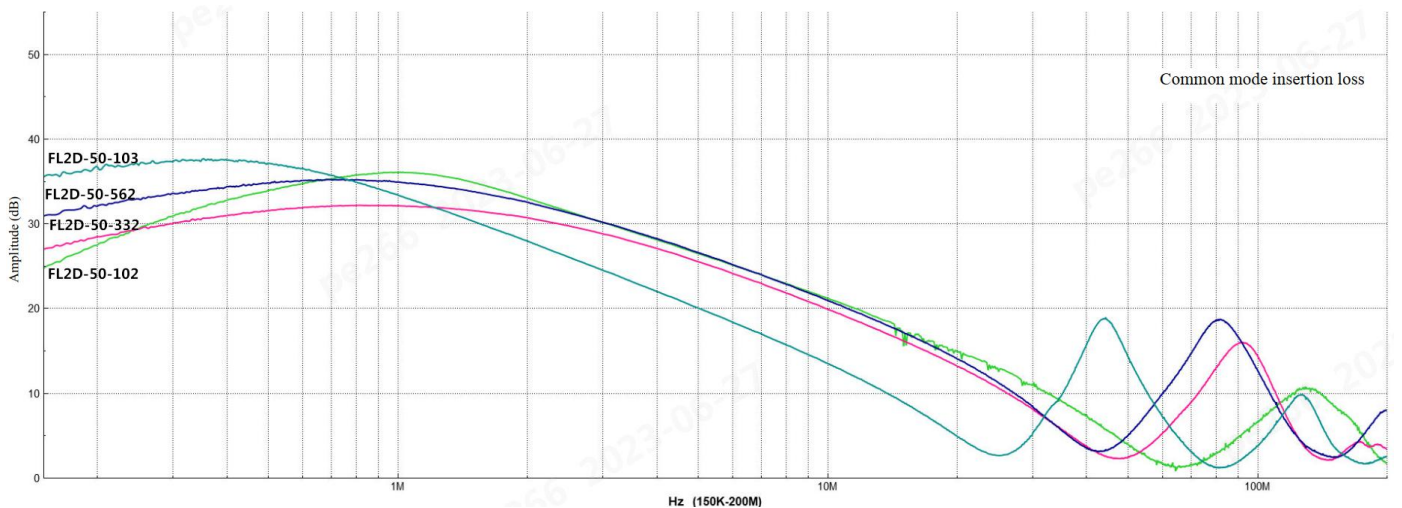
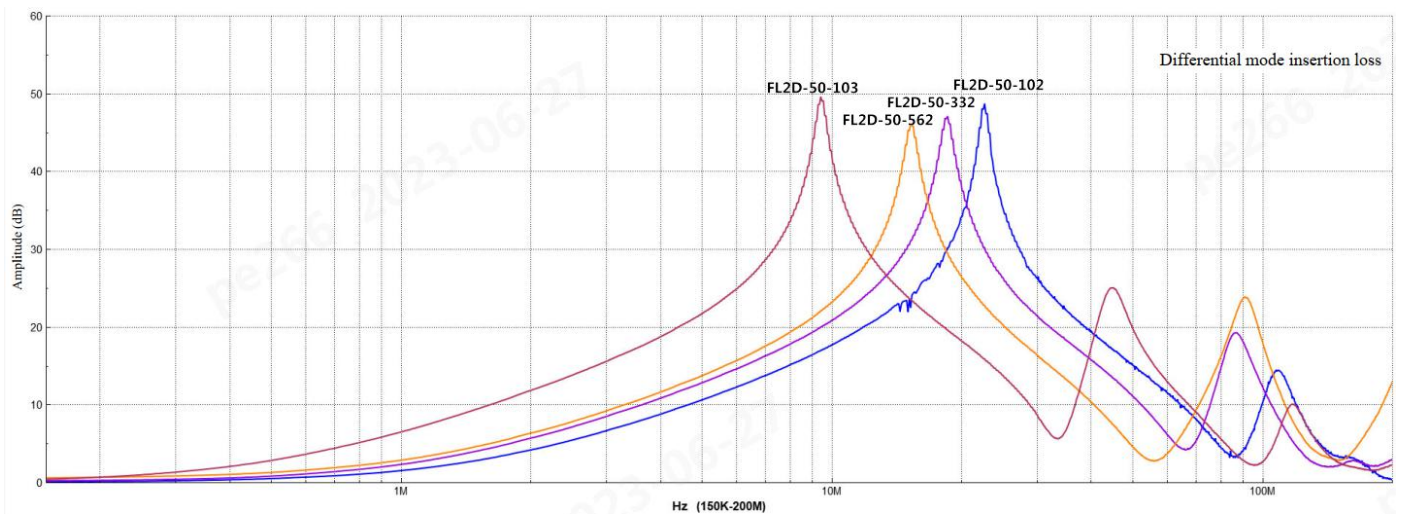

FL2D-80-xxx Insertion Loss Specifications (reference value)

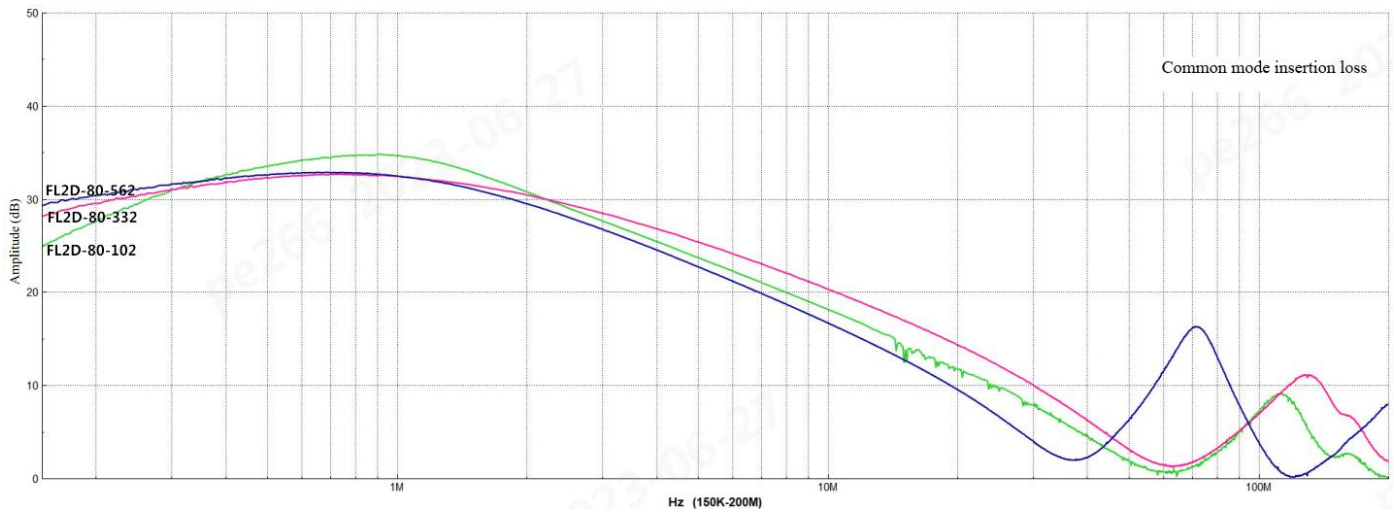
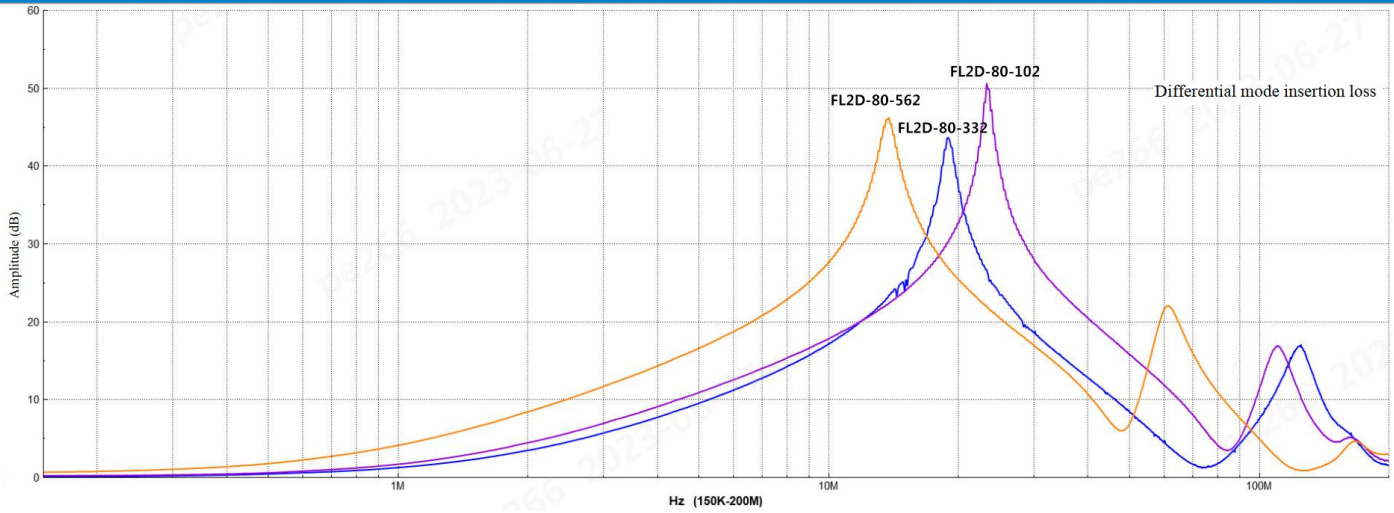

FL2D-50-102/332/562 Appearance dimensions, suggested printing layout

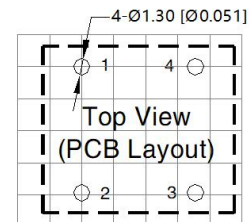
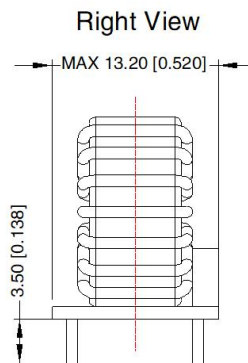
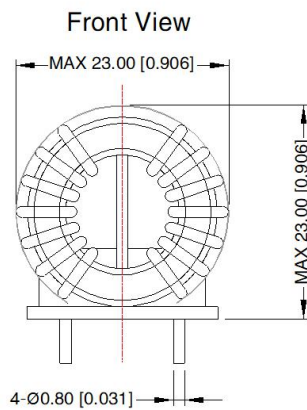
THIRD ANGLE PROJECTION 

Note: Grid 2.54*2.54mm

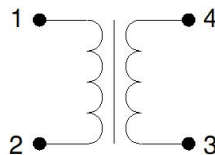
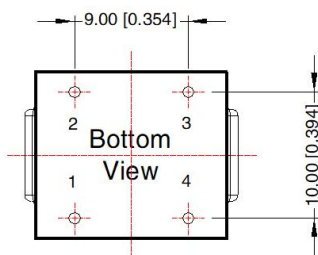

Note:

Unit: mm[inch]

Pin diameter tolerances: $\pm 0.10 [\pm 0.004]$ General tolerances: $\pm 0.50 [\pm 0.020]$

FL2D-50-103 Appearance dimensions, suggested printing layout

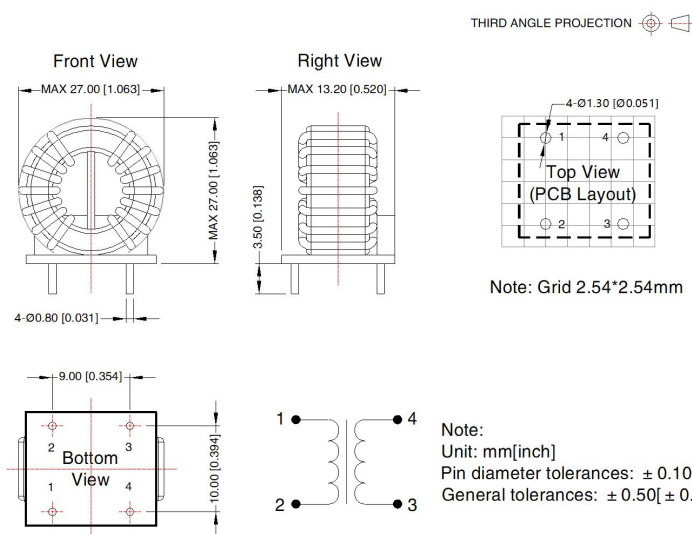

FL2D-80-102/332 Appearance dimensions, suggested printing layout

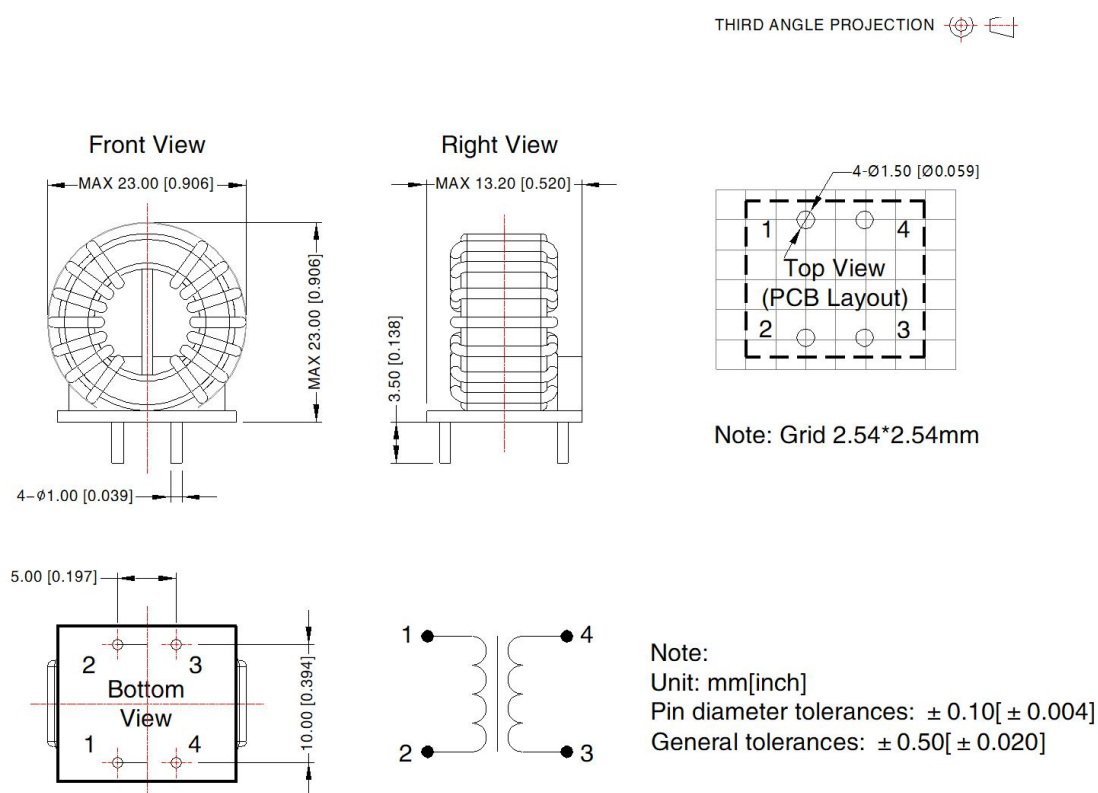

FL2D-80-562 Appearance dimensions, suggested printing layout

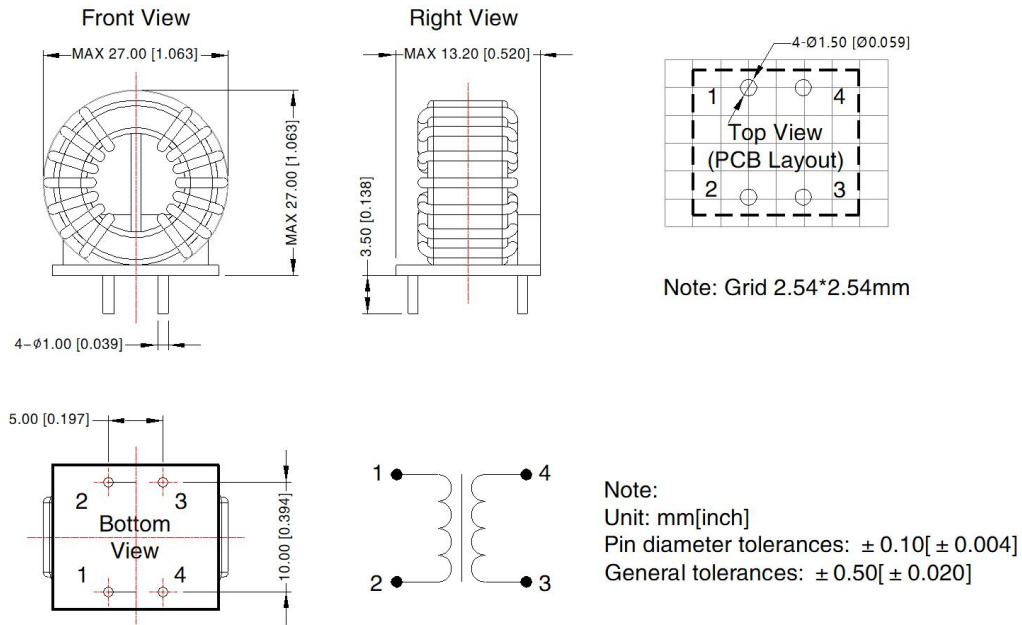
THIRD ANGLE PROJECTION 

Note:

- For additional information on Product Packaging please refer to www.mornsun-power.com. Packaging bag number: 58200055
- Unless otherwise specified, data in this data sheet should be tested under the conditions of $T_a=25^{\circ}\text{C}$, humidity<75%RH;
- All index testing methods in this datasheet are based on company corporate standards;
- The performance indexes of the product models listed in this manual are as above, but some indexes of non-standard model products will exceed the above-mentioned requirements, and please directly contact our technicians for specific information;
- We can provide product customization service, please contact our technicians directly for specific information;
- Products are related to laws and regulations: see "Features" ;
- Our products shall be classified according to ISO14001 and related environmental laws and regulations, and shall be handled by qualified units.

Mornsun Guangzhou Science & Technology Co., Ltd.

Address: No. 8 Nanyun 4th Road, Huangpu District, Guangzhou, China

Tel: 86-20-38601850

Fax: 86-20-38601272

E-mail: info@mornsun.cnwww.mornsun-power.com